

The Elevator Bolt Locking System is used on top trays on Best easels. The 2 metal plates and round plastic guide keep the parts parallel which

allows for smoothness and ease when the tray is moved into position. By tightening the knob, the circular plate will seal itself against the mast. This means ultimate stability for the canvas.

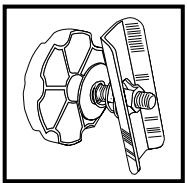

Height & tray adjustments unlock easily, yet lock into place & stay locked because of the Wedge-lok System. The metal plate features wedge-cut edges that conform

to the wedge-cut sections of the hardwood. When the knob is tightened, the inward tension pulls the metal plate snugly against the wood for a solid lock.

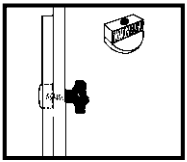

Slide Guides make angle and height adjustments on Best easels smooth. These circular graphite impregnated plastic inserts are used

wherever there is a slot in the wood of the easel. This part allows for smooth movement and protects the hardwood from the metal bolt.

2) Lay the frame on the top of the base and screw the hinges to the base with the 5/8" screw and screw in both sides. Holes are pre-drilled.

1) Check external & internal box for damages. Damage to box must be reported to UPS or trucking company for claim. Once it leaves the warehouse, we are not responsible for damages. The BEST easels have been boxed for minimal damage. The corrugated boxes are made of 350# cardboard.

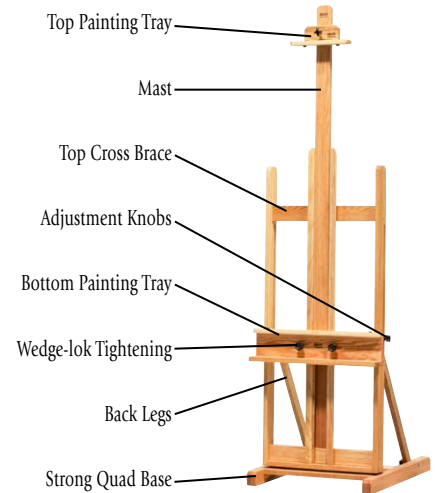

4) Loosen the knob behind the easel all the way up and slide the mast into the slot.

5) Canvas holders are inner boxed. Loosen the black knobs on top canvas holders until white plastic stop has been recessed into cavity. Mount the bottom tray on the easel by sliding it over the widest part of the mast & tighten knobs to the desired height. (DO NOT USE TOOLS.)

3) Loosen the two black knobs on interior of easel base. Adjust the back legs to fit into the slots on the frame (both sides). Attach with the 2-1/2" bolt slide guides and knobs found in enclosed bag. Stand easel erect and tighten all four knobs to the angle of personal desire. (DO NOT USE TOOLS.)

